

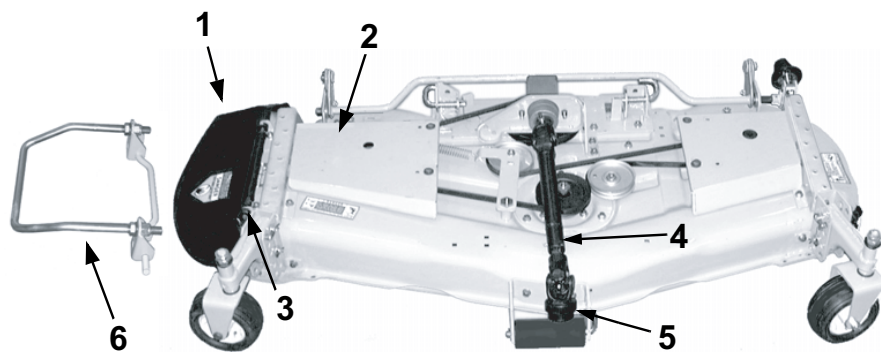

1

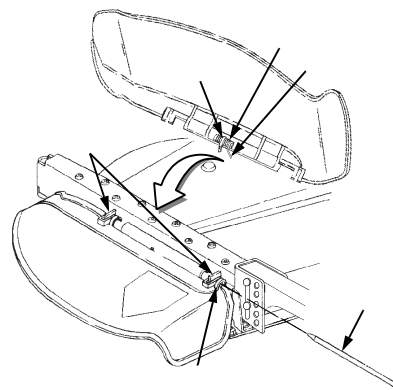

2



3a

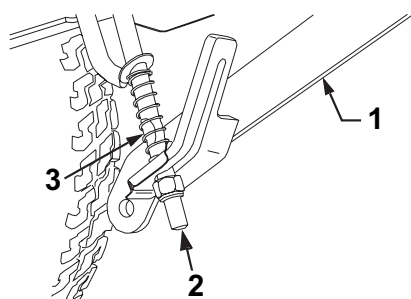

3b

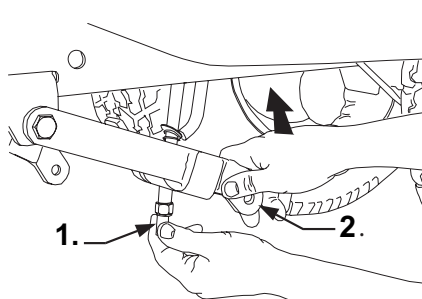

3c

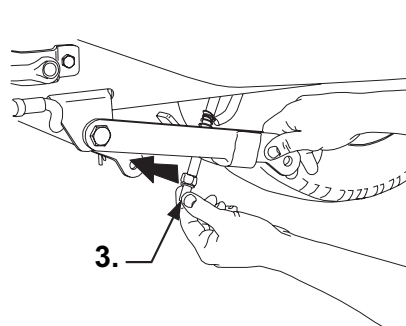

3d

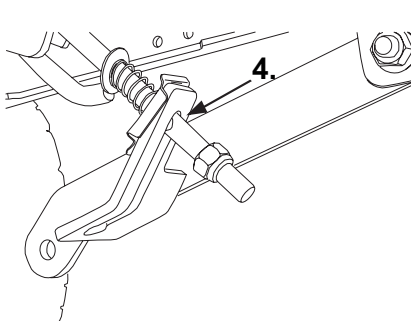

4

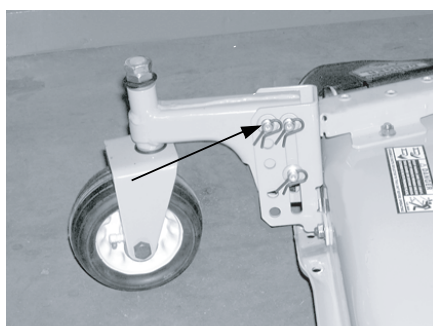

5

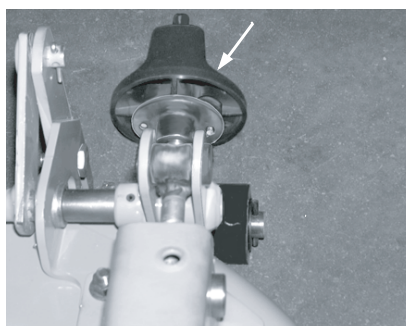

6

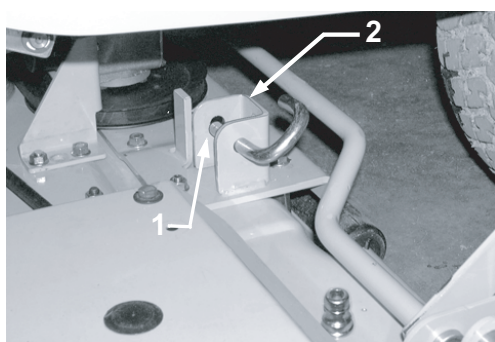

7

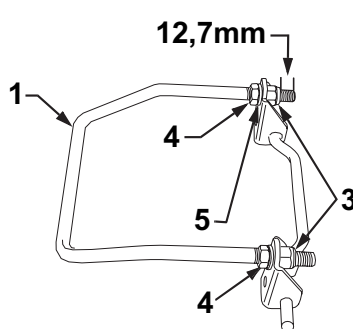

8

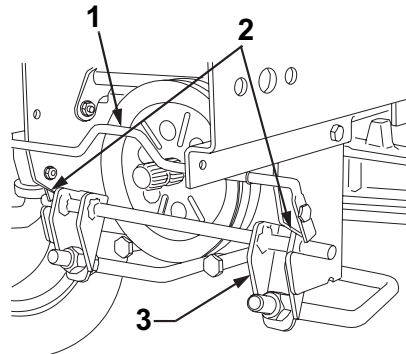

9a

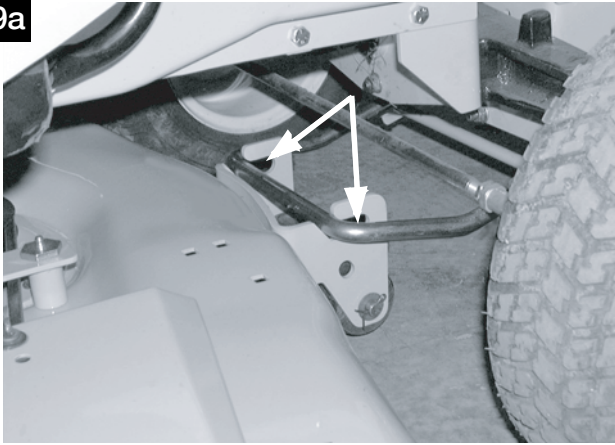

9b

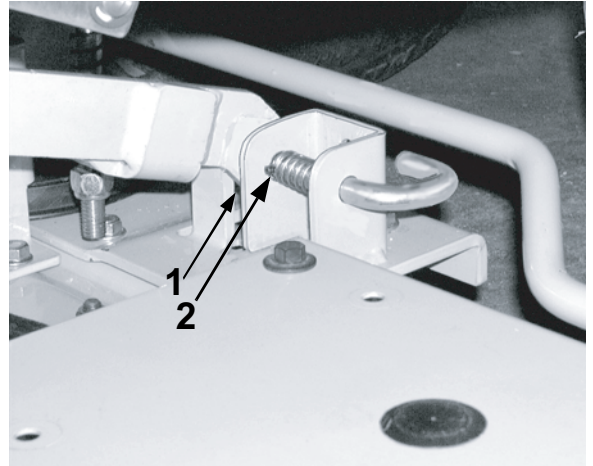

10

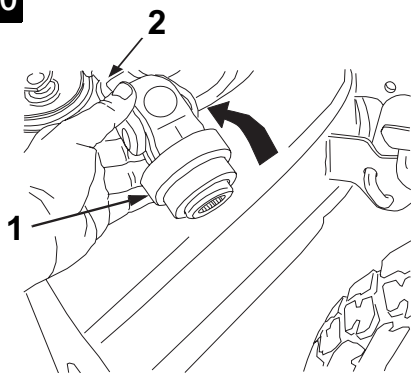

11

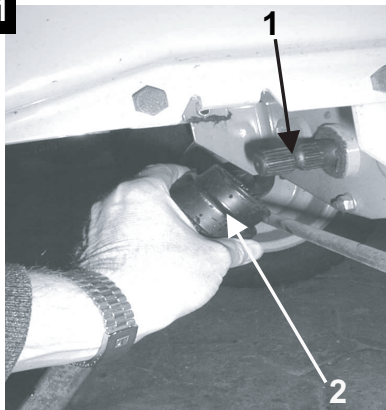

12

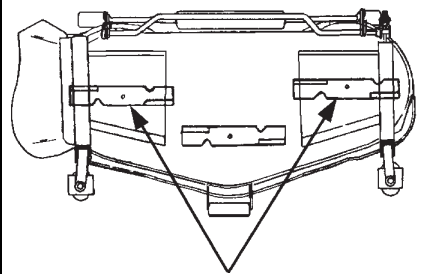

13

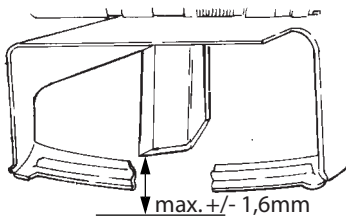

14

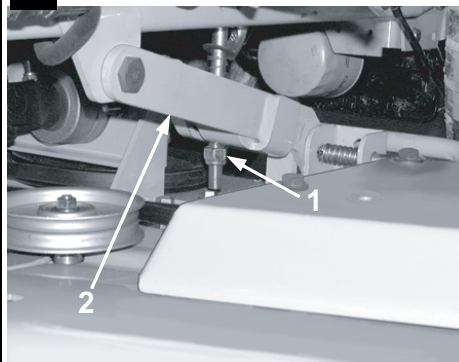

15a

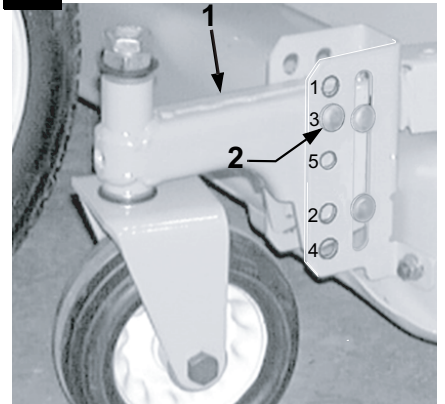

15b

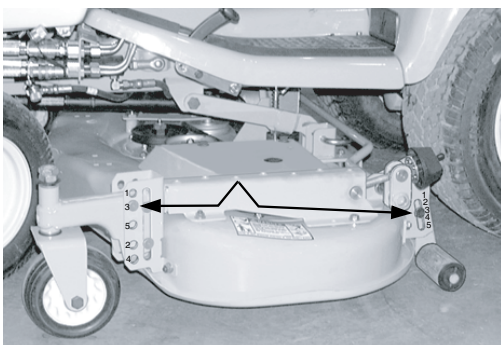

16

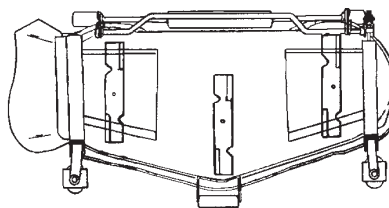

17

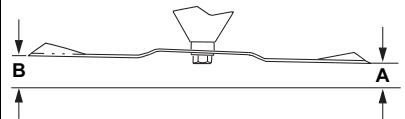

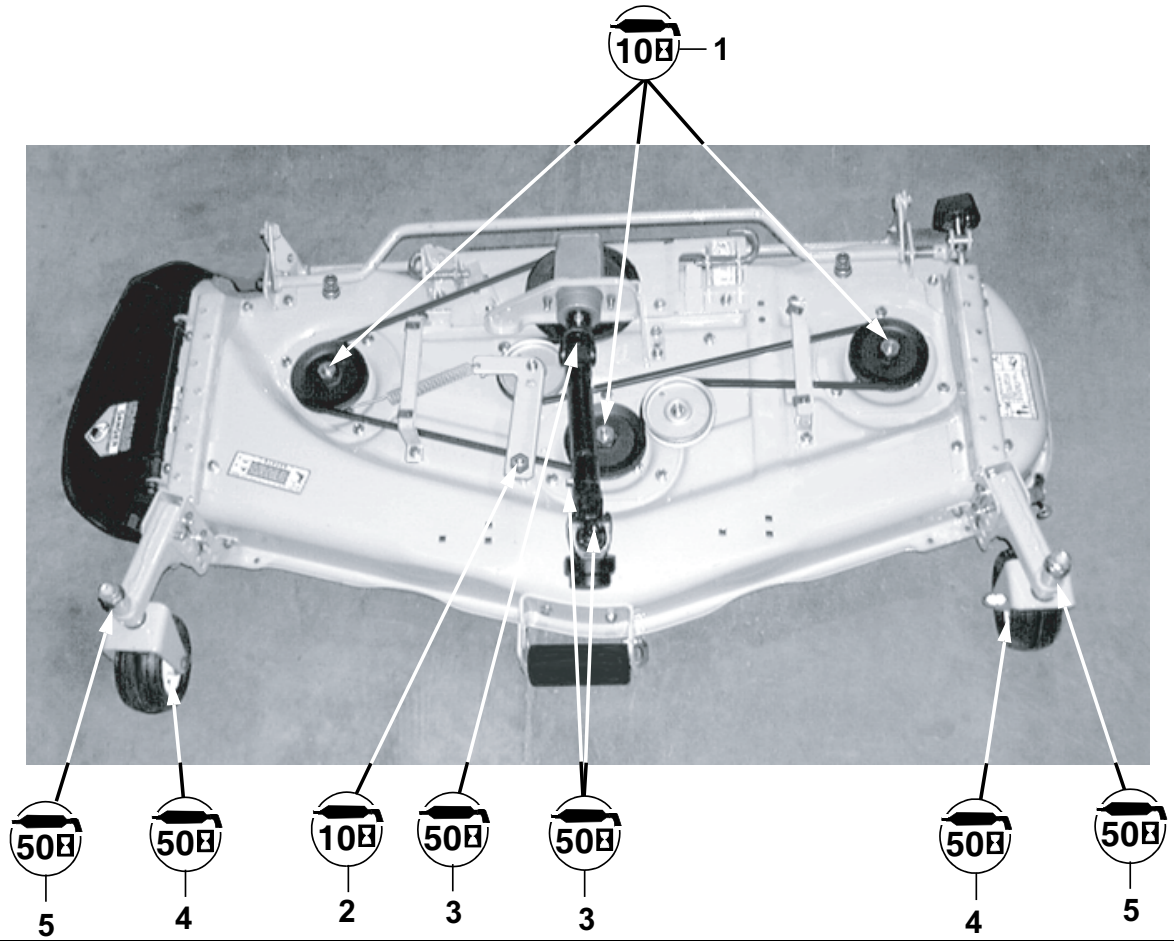



English



Français



Deutsch



Nederlands



Español



Svenska



Dansk

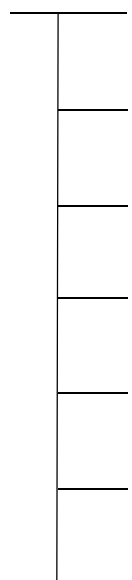

Table of Contents

For your safety	4
At a glance	4
Assembling the appliance	4
Installing / removing the mower	4
Settings	5
Maintenance	6

For your safety

Read these instructions carefully before proceeding with any work on or with the appliance. Observe all operating and safety information and the instructions for the lawn tractor this mower is attached to. Have repair work carried out by a specialist workshop only.

Using the unit appropriately

The unit is intended for use

- for mowing lawns in conjunction with the corresponding lawn tractor
- in accordance with the descriptions and safety instructions indicated in this operating manual,

The appliance must not be put to any other use. The operator is liable for all damages to third parties and their property. The manufacturer accepts no responsibility for damages resulting from unauthorised alterations to the unit that have been carried out by the owner or operator.

Before all work on the unit

Protect yourself against injury.

Before all work on this unit

- Switch off the engine,
- Take out the ignition key,
- Actuate the parking brake,
- wait until all moving parts have come to rest and the engine has fully cooled,
- pull off the cap of the spark plug so that the engine cannot inadvertently start.

Risk of injury

Injury hazard due to sharp cutting blade. Wear protective gloves when working on the cutters.

When using the appliance

Risk of injury – Keep all persons, especially children, and all animals away from the appliance.

Safety features

The grass flap protects you against possible injuries resulting from the cutting blade or objects that are propelled by it.

The unit may only be operated with the grass flap attached.

At a glance

Figure 1

- 1 Grass flap
- 2 Mower
- 3 Securing bar
- 4 Front drive shaft
- 5 Rear drive shaft
- 6 Receiver (supplied with the tractor)

Assembling the appliance

Note

All positions are based on the tractor's drive direction.

Installing the deflector

(already fitted on some models)

Figure 2

Note

The deflector spring is secured with a cable tie for better installation. Remove this cable tie only after the deflector has been installed.

- Install the deflector so that the long end of the spring lies flat on the mower's top side, pointing to its centre.
- Guide the securing bar (with the pointed end foremost) through the aperture provided on the deflector and the mounting lugs. Make sure that the bar passes through the torsion spring to the opposite end of the baffle.
- Check that the closing spring functions correctly. The deflector must close correctly at all times under the action of the spring. You may have to twist the spring to raise its tension.
- Remove the cable tie on the spring.

Preparing the tractor for receiving the mower

Park the tractor on a level surface.

- Engage the parking brake.
- Switch off PTO.
- Press down the central hydraulics lever to lower the lifting arms and retract the mower.

Note

You may have to turn the mower UP/OWN knob to the left stop (lowest mower setting).

- Switch OFF the engine and remove the ignition key.

Securing the left lifting arm

Figs 3a–3d

- Hold firmly the connecting bar (2).
- Raise the lifting arm (1) to the recess (3).
- Press the connecting bar to the front stop to secure this.

Installing / removing the mower

Assembly

- Start the engine.
- Pull back the central hydraulics lever to raise the lifting arms to the top stop.
- Switch OFF the engine and remove the ignition key.

Setting the mower guide wheels/rollers

- Move the front guide wheels to the highest position (Fig. 4).
- Press the adjusting knob to move the rear rollers to the highest position (Fig. 5).

Note

Highest position = lowest mower setting.

Installing the mower

- Push the mower beneath the tractor from the left.
- Pull out the (left and right) J stirrups on the mower receiver (2) and secure these to the inner panel (1) – Fig. 6.
- Use the central hydraulics lever to lower the lifting arms on the tractor.
- Loosen the secured left lifting arm (press the connecting bar to the back stop).
- Set the receiver (1) (for the first installation only) – Fig. 7.
 - Loosen the nuts (4).
 - Unscrew the nuts (3) to a distance of about 12.7 mm from the end of the thread.
- Secure the receiver (3) to the front of the tractor (Fig. 8).
 - Hook the outer ends in the recesses (2).
 - Press back the receiver until both sides are held and secured in the locking stirrups (1).
- Push the mower to the front and hook it into the receiver (Fig. 9a).
- Push back the mower so that the receiver sits over its whole length to the stop in the mount.
- Secure the left and right lifting arms on the mower (Fig. 9b).
 - The lifting arms must sit in the recesses (1).
 - Align the lifting arms' mounting holes to the holes in the mower receiver (2).
 - Use the J stirrups to secure the lifting arms to the mower receivers. Make sure that the J stirrups engage correctly.

i Note

You may have to continue unscrewing the nuts (3) on the receiver before you can push back the mower further. You must then retighten the nuts (4) accordingly (Fig. 7).

The following work must be performed for the first installation only.

- Tighten the nuts (3) on the receiver until it sits firmly in the mower's mount (to the stop on both sides). Now tighten the nuts (4) – Fig. 7.
- Push back the automatic closure (1) on the drive shaft (2) and hold this in position (Fig. 10).
- Push the whole drive shaft (2) on the PTO (1) and release the closure (Fig. 11).

i Note

When seated correctly the closure engages in a locking position – please check this.

Detaching the mower

- Park the tractor on a level surface.
- Engage the parking brake.
- Switch off PTO.
- Switch OFF the engine and remove the ignition key.
- To draw the drive shaft off the PTO (Fig. 11): push back the closure and draw off the drive shaft.
- Start the engine.
- Retract the entire mower at the central hydraulics lever.
- Switch OFF the engine and remove the ignition key.
- Move the front guide wheels to the highest position (Fig. 4).
- Press the adjusting knob to move the rear rollers to the highest position (Fig. 5).

i Note

Highest position = lowest mower setting.

- Lower the mower at the central hydraulics lever.
- Pull out the (left and right) J stirrups on the mower receiver (2) and secure these to the inner panel (1) – Fig. 6.
- Secure the left lifting arm (Figs 3a–3d).
 - Hold firmly the connecting bar (2).
 - Raise the lifting arm (1) to the recess (3).
 - Press the connecting bar to the front stop to secure this.
- Start the engine.

- Use the central hydraulics lever to raise the lifting arms to the top stop.
- Switch OFF the engine and remove the ignition key.
- Push the mower to the front and unhook the receiver (Fig 9a).
- Press down the locking stirrup (1) and remove the receiver (3) – Fig. 8.
- Pull out the mower from beneath the tractor to the left side.

Settings

- Park the tractor on a firm level surface.
- Engage the parking brake.
- Switch off PTO.
- Switch OFF the engine and remove the ignition key.
- Check the tyre pressure – this must be the same for all tyres.

Mower level settings

If the mower is to achieve the optimal cutting results it must be set accordingly.

Setting the side level

- Start the engine.
- Retract the entire mower at the central hydraulics lever.
- Switch OFF the engine and remove the ignition key.
- Move the front guide wheels and the rear rollers to the highest position so that they do not touch the ground.
- Turn carefully (risk of injury!) the outer cutters transverse to the drive direction (Fig. 12).
- Measure the distance between the ground and the ends of the two outer cutters. The difference may not exceed ± 1.6 mm (Fig. 13). You may have to turn the setting nut (1) on the left lifting arm (2) to obtain the correct level (Fig. 14).

Setting the front-rear level

- Move the front guide wheels and the rear rollers to the highest position.
- Turn carefully (risk of injury!) the outer cutters parallel to the drive direction (Fig. 16).
- Measure the distance between the ground and both ends of the two outer cutters. The front cutter ends (A) should lie about 3.2 mm lower than the rear cutter ends (B) – Fig. 17. You may have to adjust the front receiver (1). To do so, loosen the locknuts (4) and turn the setting nuts (3) steadily to obtain the correct level. After setting, retighten the locknuts (4) – Fig. 7.

i Note

Both sides of the receiver must sit evenly over its whole length to the stop in the front mower mount.

Setting the cutting height**i Note**

Adjust the cutting height only after the mower level has been set correctly.

If the tractor is fitted with a mower UP/OWN knob this can be used to set the cutting height, otherwise you can adjust the guide wheels / rear rollers.

Setting the cutting height at the guide wheels / rear rollers

Figure 15

Position 1 = lowest mower setting

Position 5 = highest mower setting

i Note

The bottom hole on the guide wheel arm (1) is used for height positions 2 and 4.

- Start the engine.
- Raise the mower from the ground at the central hydraulics lever.
- Switch OFF the engine and remove the ignition key.
- Secure both guide wheels on each side in the same position hole with bolts, washers, and spring cotters.
- Pull out the setting knob (1) and turn the rear rollers to set these to the same index as the guide wheels (Fig. 15b).
- Release the setting knob and turn it to the next hole until the retaining pin (on the setting knob) engages.

i Note

The mower's weight can press down on the rear rollers so the front-rear cutter level should again be checked at the right cutter.

- Set the outer cutters parallel to the drive direction (Fig. 16).
- Lower the mower to the ground.
- The front cutter ends (A) should lie about 3.2 mm lower than or at the same level as the rear cutter ends (B) – Fig. 17. You may have to adjust the rear rollers accordingly.

i Note

Make sure the setting knob engages correctly.

Setting the cutting height at the mower UP / DOWN knob on the tractor

Note

Set the cutting height only on the retracted mower.

- Move the guide wheels/rear rollers to the highest position.
- Set the mower's lowering depth at the UP/DOWN knob.
- Lower the mower to the set depth.
- Turn the UP/DOWN knob clockwise until it turns freely.
- Turn the UP/DOWN knob to the next engage position and let it engage there.
- Adjust the guide wheels and rear rollers to a height of about 1 cm above the ground (with the mower lowered).

Maintenance



Before all work on the unit

Protect yourself against injury. Before all work on this unit

- Switch off the engine,
- Take out the ignition key,
- Actuate the parking brake,
- wait until all moving parts have come to rest and the engine has fully cooled,
- remove the spark plug connector on the engine in order to prevent the engine from accidentally being started.

At the end of the grass-cutting season, have the lawn scarifier checked and serviced in a specialist workshop.

Cleaning

Information on how to clean the mower can be taken from the instructions for the tractor.

Lubricating

Use commercially available grease guns and oilcans for all lubricating work.

Use 251H EP grease or similar multi-purpose lithium grease, no. 2.

Apply a high-quality lubricating oil to all moving parts without a grease nipple. Lubricate the mower in accordance with the lubrication chart (Fig 18) every ten or fifty operating hours and before winterising the appliance.

Figure 18

- 1 cutter shaft bearing
- 2 tensioning arm
- 3 universal shaft
- 4 guide wheels
- 5 guide wheel spindle